

HELI

CBD15J/20J-(D)Li Lithium Battery Powered Pallet Truck

Heli Mini power pallet with Lithium battery

Characteristics:

- Simple, flexible, light weight and small turning radius make the truck suitable use in extremely narrow aisle.
- Strong structure and open layout make the maintenance easy
- Same hydraulic pump with the hand pallet, simple and reliable
- Integrated handle integrates key and meter make the operation easy and comfortable.
- Portable lithium-battery pack provides easy and speedy battery change.
- Emergency reversing device ensure safety operation.
- Auxiliary wheels on two sides provide well stability.
- Manual lift is available as option.



CBD15J/20J-(D)Li

Manufacturer's Data and Design Characteristics				
Characteristics				
1.1	Manufacturer	HELI		
1.2	Model	CBD15J-Li	CBD15J-DLi	CBD20J-Li
1.3	operator type	Pedestrian		
1.4	rated capacity	Q (kg)	1500	2000
1.5	lift height	h3 (mm)	200	200
1.6	Service weight with battery	kg	152 156	153 (151) 157 (155)
1.7	Load centre	c (mm)	600	600
1.8	Axle centre to fork face	x (mm)	944	944
1.9	Wheel base	y (mm)	1243	1243
1.10	Controller	CURTIS		
Wheels				
2.1	Tyre type	Polyurethane		
2.2	Tyre size, driving wheels	φ × w (mm)	φ210 × 70	φ210 × 70
2.3	Tyre size, loading wheels	φ × w (mm)	φ80 × 60	φ80 × 60
2.4	Wheels, number front/rear (x = driven)		1x+2/4	1x+2/4
2.5	Track width, rear, loading side	b11 (mm)	400/535	400/535
Dimensions				
3.1	Overall length	l1 (mm)	1615	1615
3.2	Length to fork face	l2 (mm)	465	465
3.3	Overall width	b1 (mm)	550/685	550/685
3.4	Fork dimensions	s/e1 (mm)	50/150/1150	50/150/1150
3.5	Width of forks	b5 (mm)	550/685	550/685
3.6	lowered height	h13 (mm)	85	85
3.7	Min,Ground clearance	m2 (mm)	35	35
3.8	height drawbar in driving position min. / max.	h14 (mm)	610/1212	610/1212
3.9	Aisle width with pallet 1000 × 1200 across forks	Ast (mm)	1815	1815
3.10	Aisle width with pallet 800 × 1200 along forks	Ast (mm)	1865	1865
3.11	Min. Turning radius	Wa (mm)	1405	1405
Performance				
4.1	Travel speed,with/without load	(km/h)	4.2/4.5	4.2/4.5
4.2	Max. gradeability laden/unladen	(%)	5/10	5/10
4.3	Service brake type		Electromagnetic brake	Electromagnetic brake
Drive and Battery				
5.1	Drive motor,output S2 60 min.	(kW)	0.75	0.75
5.2	Lift motor rating at S3 15%	(kW)	No	0.8
5.3	Battery according to DIN 43531/35/36 A,B,C,no		No	No
5.4	Battery voltage/rated capacity	(V/Ah)	24/35	24/52 (24/20)
5.5	Battery weight (± 5%)	(kg)	7	8 (6)
5.6	charger specification		24V/10A	24V/10A
Others				
6.1	Type of drive control		DC	DC
6.2	sound pressure level at the driver' s ear	dB(A)	≤ 75	≤ 75
6.3	Steering type		Mechanical steering	Mechanical steering

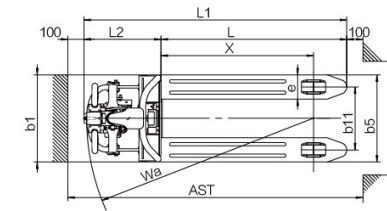
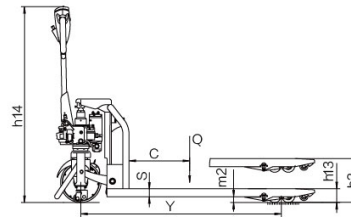

ANHUI HELI CO., LTD.
Add / No.668, FangXing Road, Hefei, China
Fax / +86-551-63639966

Tel / +86-551-63639068(America); 63639258(Europe);
63639358(Asia); 63662105(Africa & Middle East);
63639530(Key Accounts Division); 63662105(Wheel loader)